

# The Perth 3 storey, 4 Bedroom home

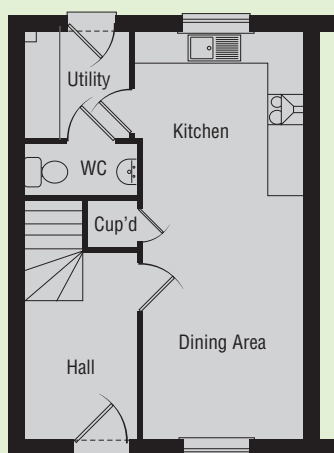

## GROUND FLOOR

Dining Area	2.87m x 4.25m 9' 5" x 13' 11"
Kitchen	2.97m x 3.03m 9' 9" x 9' 11"
Utility	1.84m x 1.92m 6' 1" x 6' 3"

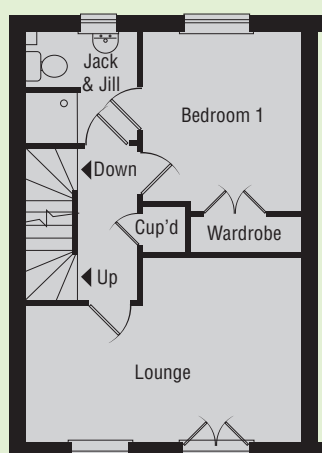

## FIRST FLOOR

Lounge	4.90m* x 3.31m* 16' 1" x 10' 10"
Bedroom 1	3.19m x 2.83m 10' 5" x 9' 3" (not including depth of wardrobes)
En suite	1.98m x 1.93m 6' 6" x 6' 3"

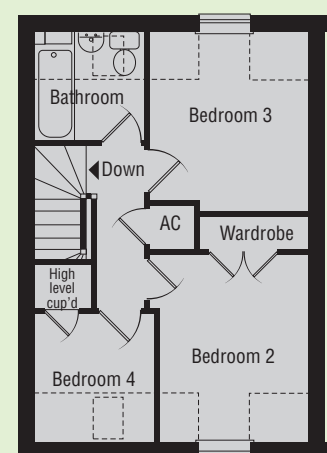

## SECOND FLOOR

Bedroom 2	2.64m x 3.31m 8' 8" x 10' 10" (not including depth of wardrobes)
Bedroom 3	2.83m x 3.18m* 9' 3" x 10' 5"*
Bedroom 4	2.16m x 2.26m 7' 1" x 7' 5"
Bathroom	1.98m x 1.92m 6' 6" x 6' 3"

Picture shows an example Perth in the style of plots 102 and 103.

\*Please note, the floor plans differ on plots 102 and 103. Please ask a Sales Adviser for more details.

Every care has been taken to ensure the accuracy of these floor plans and dimensions but the contents shall not form any part of any contract and the vendors reserve the right to alter specification and/or design without prior notice. Purchasers are advised to check individual plot details with the Sales Advisers.

\*Maximum dimensions